



Prefab pump room



The conventional construction of a pump room requires a combination of multidisciplinary teamwork among designers, building contractors, technical suppliers, electrical mechanical engineers and subcontractors. The diversity of this work requires solid coordination and consensus on site.

WB Firepacks' Prefab pump rooms are complete prefab installed pump rooms, which are delivered ready-to-use on the project. It is a "plug and play" solution.

Benefits of a Prefab pump room:

- ✓ The Prefab pump room is ready to use and equipped completely. All that remains is connecting suction, discharge and test flanges to the sprinkler system and supplying the Prefab with electrical power.
- ✓ The Prefab pump room will be fully tested before delivery. We offer our customers the opportunity to attend a Factory Acceptance Test in our well-equipped test facility.
- ✓ The Prefab pump room can be designed to meet almost any requirements. We have already built Prefab pump rooms containing built-in water and foam tanks. Your requirements are the beginning of the project with creative solutions.
- ✓ We deliver reliable installations that meet the highest standards.

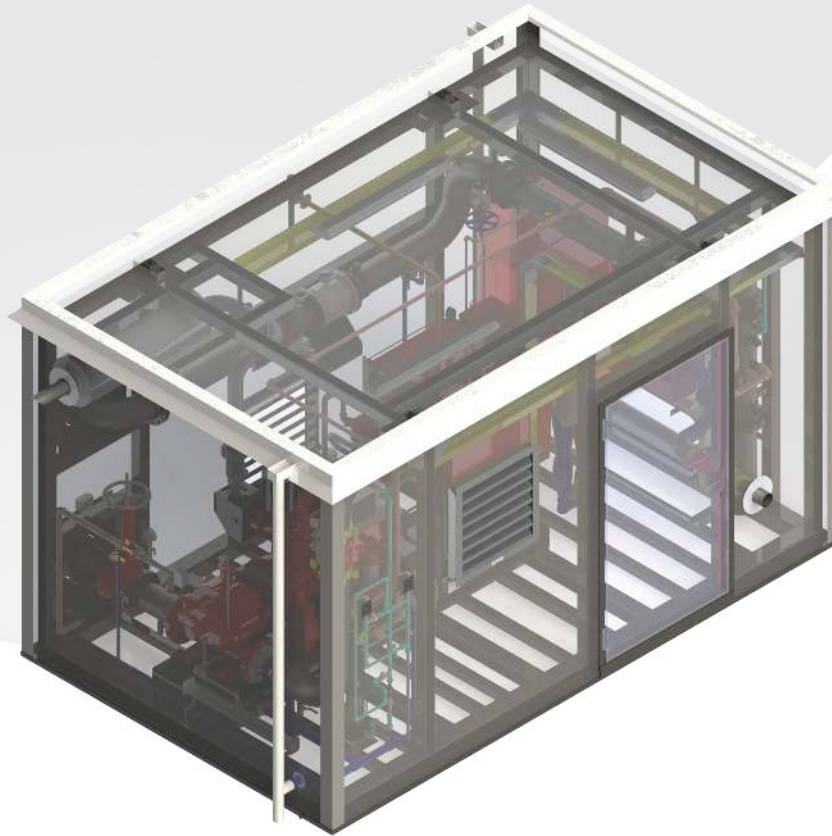

Specifications:

- Standard dimensions are 6, 8, 10 and 12 meters. Would you like a different format? Please contact us to discuss this.
- The standard width is approx. 3.2 m, larger pump rooms with multiple installed units are possible by aligning multiple Prefab pump rooms with open walls.

Structure:

- Stable steel frame construction built on a reinforced and torsional rigid floor construction.
- Walls and ceilings covered with sandwich panels (80 mm) for acoustic and thermal insulation.
- Floor mounting includes all necessary foundations and fixings for the aggregates and the interior.
- Walkable floor space designed with plywood panels and additionally designed with aluminum drain plates.
- Cockpit cover with drainage via downspouts.
- Central drainage of the leakage water in the floor surface.

Equipment:

- Pipes for suction, pressure, test, auxiliary and control pipes, dimensioned according to the standard or as desired. Standard sprinkler ceiling protection.
- Pipes from a nominal width of 2" finished in RAL 3001 with flange connections in the desired pressure classes.
- Pipes up to a nominal width of 2" are made as galvanized wire pipes.
- All necessary fittings and fittings according to standard.
- Complete electrical equipment comprising lighting, heating, ventilation and main subdivision. Cable entries as required in the floor or side wall area.

Factory Acceptance:

- The complete installation is subjected to a full load test and a pressure test on the WB Firepacks test bench.
- Associated test reports are part of the final documentation.
- The tests can be viewed in consultation.

Unique combination of experience and knowledge

This concept has evolved over 40 years of combining experience of WB Firepacks and supported by the knowledge and experience of a professional construction company and a well-known electrical installation company.

Our company is one of the most modern and respected suppliers in the field of Firepacks. We design, manufacture and test all Firepacks in house. With respect to reliability and problem-free operation, our Firepacks offer first-class fire protection.

Reliability is the keyword for all our personnel at every level in our organization.

Over 10.000 companies in the world depend on reliability of our Firepacks, 24 hours a day, all year around. WB Firepacks always concentrates its efforts on the total concept of fire fighting!



Hoedemakersstraat 14 | Zwijndrecht | Netherlands
+31 (0)78 623 15 00 | firepacks@firepacks.com
www.firepacks.com